

REVISION

| | | |
|-----------|-----------|------------------------|
| A | DU | D FRALEY |
| 9/25/2007 | ECN-80802 | RELEASE FOR PRODUCTION |

| | | |
|-----------|-----------|----------|
| B | JB | D FRALEY |
| 10/9/2008 | ECN-98691 | |

SHT 1, BOM CHG WT-29-01-F TO WT-29-07-F, TOP VIEW; DEL C13 DIM 22.50, ADD DIM 22.60 REF; FRONT VIEW; DEL DIM 22.60 REF, ADD DIM C13 22.50.

NOTES:

1. CONTACT CONFIGURATION NOT AVAILABLE AS STANDARD.
2. Ⓢ REPRESENTS A CRITICAL DIMENSION.
3. MAXIMUM BURR ALLOWANCE: .038[.0015].
4. MINIMUM PUSHOUT FORCE: 2.22N [.5 LB].
5. PARTS TO BE PACKAGED IN TRAYS.

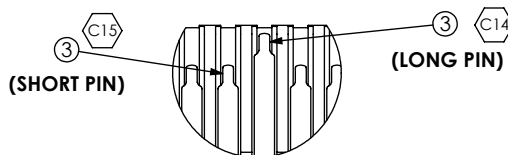
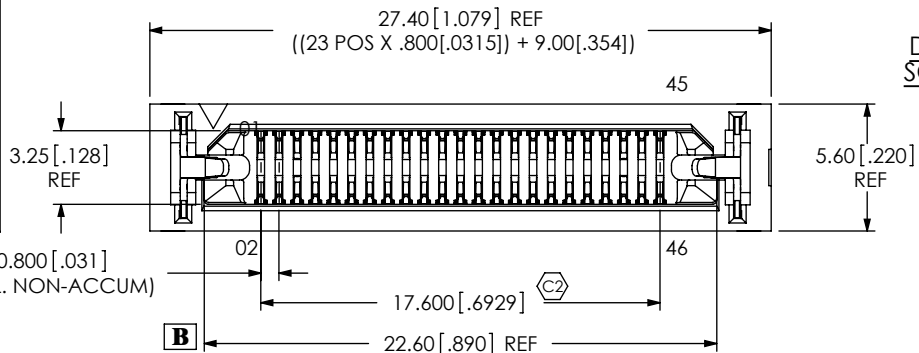

DETAIL 'D'
SCALE 6:1

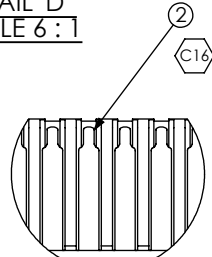

DETAIL 'C'
SCALE 6:1

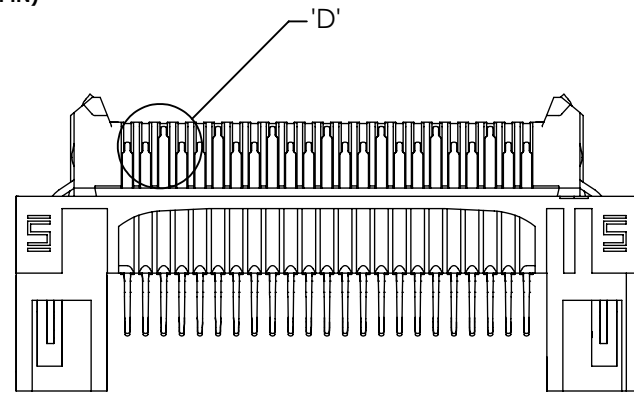

ODD ROW (DP SIDE, HOT PLUG SIDE)

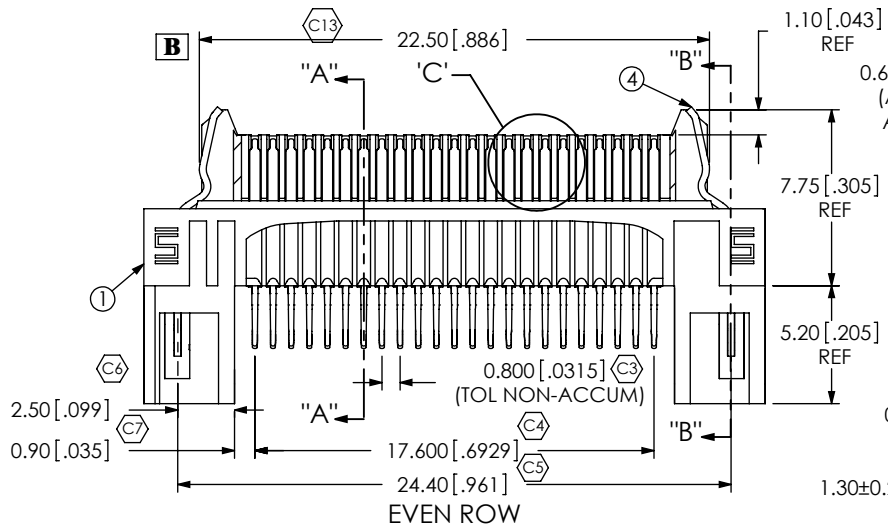

EVEN ROW

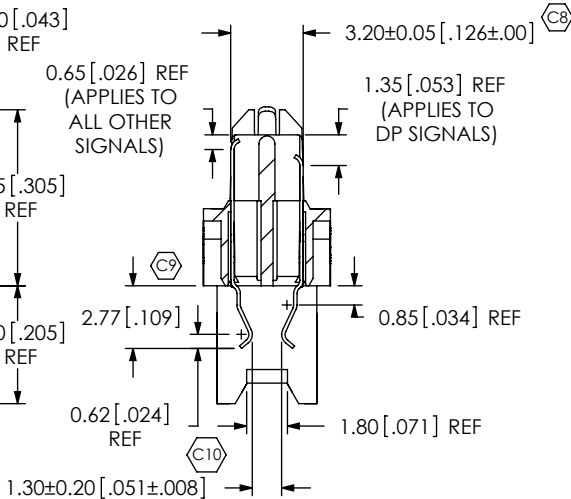

SECTION "A"-"A"

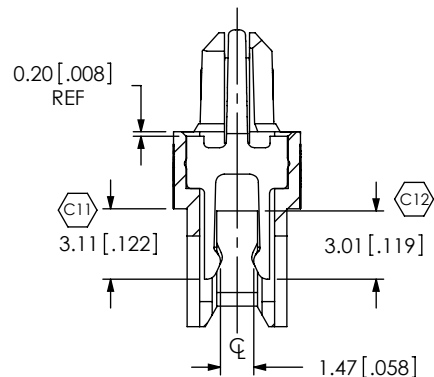

SECTION "B"-"B"

DATE: _____
 COMPANY: _____
 CUSTOMER SIGNATURE _____
 PRINTED NAME _____
 PHONE NO: _____
 FAX NO: _____

ACCEPTANCE OF DRAWING
 ACCEPTED WITH DEVIATIONS LISTED

| ITEM NO. | PART NUMBER | QUANTITY | MATERIAL |
|----------|---------------------|----------|---------------------------|
| 1 | ERM8-023-D-EM2 | 1.0000 | VECTRA E130i, COLOR:BLACK |
| 2 | T-1M47-01-S | 23.0000 | PHOS BRONZE, 521 HT |
| 3 | T-1M47-03-S | 23.0000 | PHOS BRONZE, 521 HT |
| 4 | WT-29-07-F | 2.0000 | BeCu #25, 1/2 HT |
| 5 | TY-ERM8030-23-EM2-L | 1.0000 | BLACK HIPS |

UNLESS OTHERWISE SPECIFIED, DIMENSIONS ARE IN INCHES.
 TOLERANCES ARE:
 DECIMALS ANGLES
 .X: ±.3[.01] 2°
 .XX: ±.13[.005]
 .XXX: ±.051[.0020]

PROPRIETARY NOTE
 THIS DOCUMENT CONTAINS INFORMATION CONFIDENTIAL AND PROPRIETARY TO SAMTEC, INC. AND SHALL NOT BE REPRODUCED OR TRANSFERRED TO OTHER DOCUMENTS OR DISCLOSED TO OTHERS OR USED FOR ANY PURPOSE OTHER THAN THAT WHICH IT WAS OBTAINED WITHOUT THE EXPRESSED WRITTEN CONSENT OF SAMTEC, INC.



520 PARK EAST BLVD, NEW ALBANY, IN 47150
 PHONE: 812-944-6733 FAX: 812-948-5047
 e-Mail: info@SAMTEC.com code: 55322

DO NOT SCALE DRAWING SHEET SCALE: 3:1
 PLATING:
 CONTACT AREA: .000030 GOLD OVER .000050 NICKEL
 REMAINDER: .000200 REF TIN OVER .000050 NICKEL
 LATCHES: .000003 GOLD OVER .000050 NICKEL

DESCRIPTION: MODIFIED ERM8 ASSEMBLY
 DWG. NO. ASP-133811-02
 BY: D UNDERWOOD 7/10/07 SHEET 1 OF 2

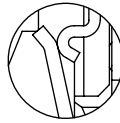
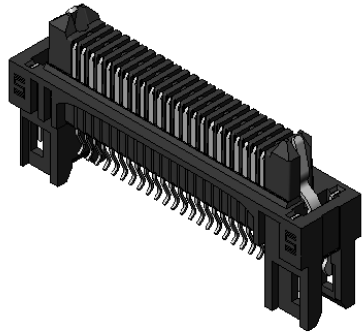

DETAIL 'G'
SCALE 6:1

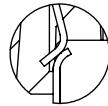

DETAIL 'H'
SCALE 6:1

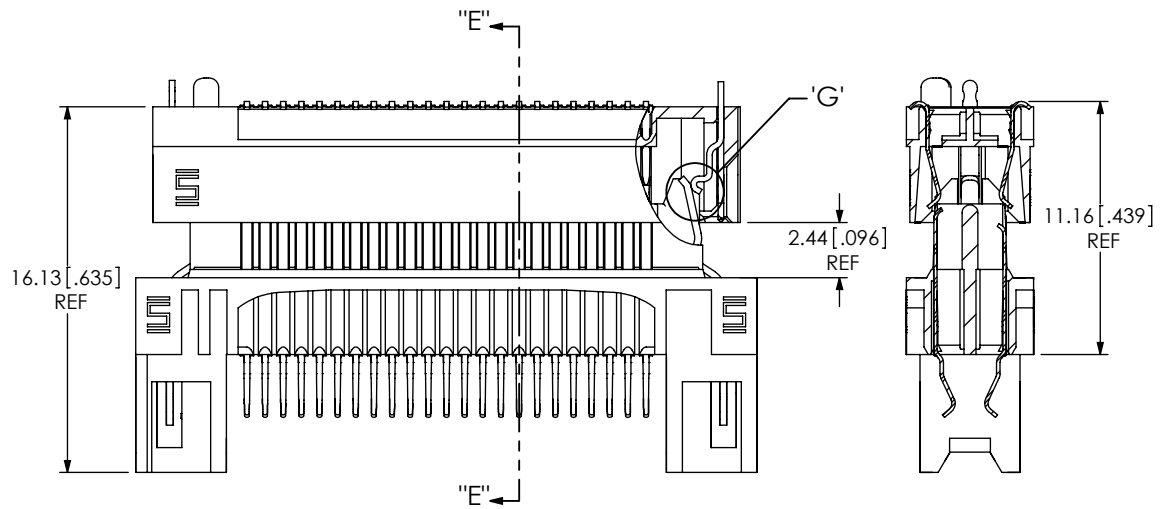

LATCH ENGAGING VIEW

SECTION "E"-E"

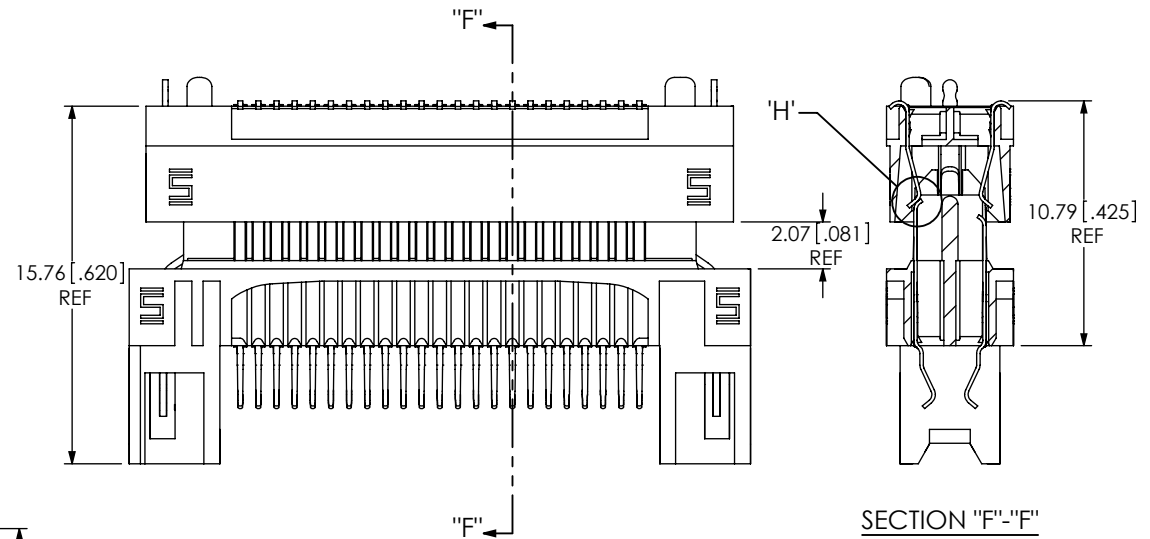

PIN ENGAGING VIEW

SECTION "F"-F"

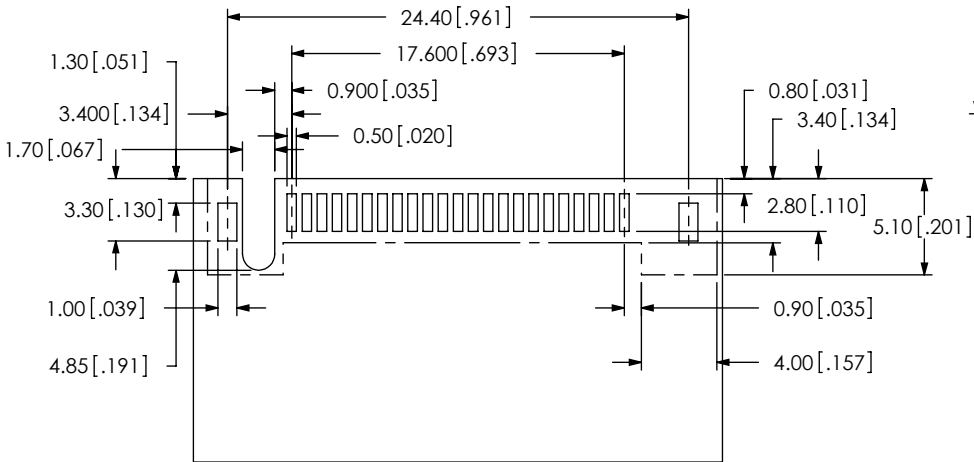

RECOMMENDED PCB LAYOUT

PROPRIETARY NOTE

THIS DOCUMENT CONTAINS INFORMATION CONFIDENTIAL AND PROPRIETARY TO SAMTEC, INC. AND SHALL NOT BE REPRODUCED OR TRANSFERRED TO OTHER DOCUMENTS OR DISCLOSED TO OTHERS OR USED FOR ANY PURPOSE OTHER THAN THAT WHICH IT WAS OBTAINED WITHOUT THE EXPRESSED WRITTEN CONSENT OF SAMTEC, INC.



520 PARK EAST BLVD, NEW ALBANY, IN 47150
PHONE: 812-944-6733 FAX: 812-948-5047
e-Mail: info@SAMTEC.com code: 55322

SHEET SCALE: 3:1

DESCRIPTION: MODIFIED ERM8 ASSEMBLY

DWG. NO. ASP-133811-02