

NOTES:

1. CONTACT CONFIGURATION NOT AVAILABLE AS STANDARD.
2. Ⓢ REPRESENTS A CRITICAL DIMENSION.
3. MAXIMUM BURR ALLOWANCE: .038 [.0015].
4. MINIMUM PUSHOUT FORCE: 2.22N [.5 LB].
5. PARTS TO BE PACKAGED IN TRAYS.

REVISION

0	DF	S HILLERICH
4/3/2007	ECN-74132	ISSUE FOR REVIEW.
0	DF	D FRALEY
3/24/2008	ECN-88099	ISSUE FOR REVIEW.
A	TP	D Fletcher
4/29/2008	ECN-89954	RELEASE FOR PRODUCTION; CHG TRAY TY-ERM8042-11-5 TO TY-ERM8057-11-5-L
B	MM	E Fox
6/1/2009	ECN-111187	FRONT VIEW: CHG DIM "14.16" TO "13.70".

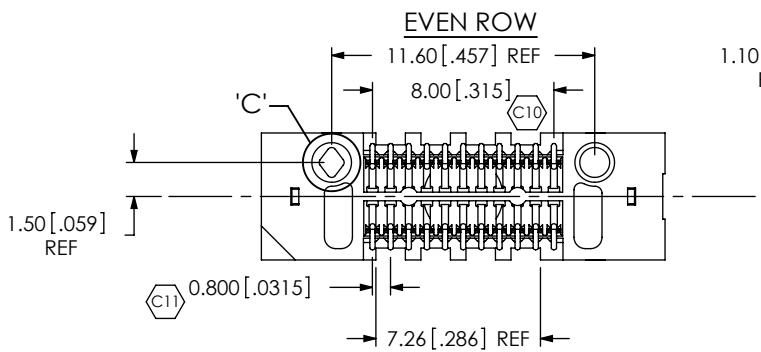
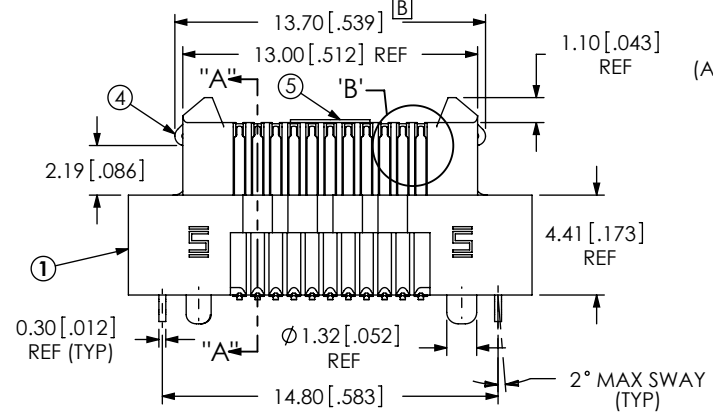
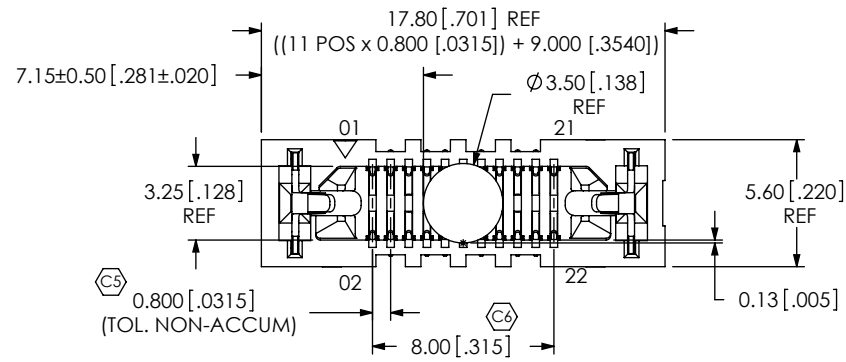

0.64 [.025] REF (APPLIES TO ALL OTHER SIGNALS)

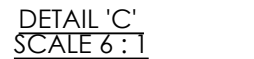
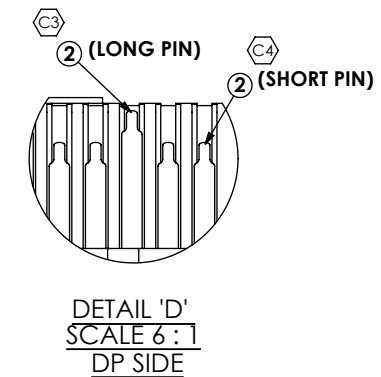
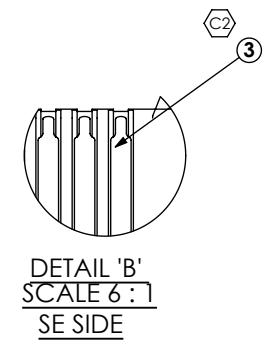
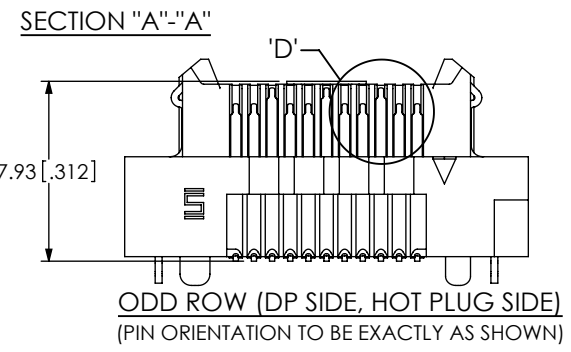
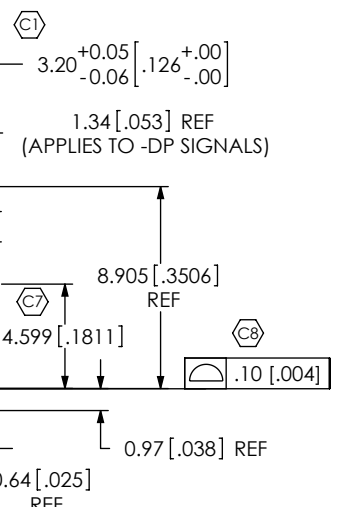

ACCEPTANCE OF DRAWING
ACCEPTED WITH DEVIATIONS LISTED

DATE: _____
COMPANY: _____
CUSTOMER SIGNATURE _____
PRINTED NAME _____
PHONE NO: _____
FAX NO: _____

ITEM NO.	PART NUMBER	QUANTITY	MATERIAL
1	ERM8-011-05.0-DV-L	1.00000	VECTRA E130i, COLOR: BLACK
2	T-1M48-05.0-S	11.00000	PHOS BRONZE, 521 HARD TEMPER
3	T-1M37-05.0	11.00000	PHOS BRONZE, 521 HARD TEMPER
4	WT-29-03-F	2.00000	BeCu #25, 1/2 HT
5	K-500-300	1.00000	POLYIMIDE FILM (KAPTON)
6	TY-ERM8057-11-5-L	1.00000	BLACK HIPS

UNLESS OTHERWISE SPECIFIED, DIMENSIONS ARE IN INCHES. TOLERANCES ARE:
DECIMALS ANGLES
.X: ±.3[.01] 2°
.XX: ±.13[.005]
.XXX: ±.051[.0020]

PROPRIETARY NOTE
THIS DOCUMENT CONTAINS INFORMATION CONFIDENTIAL AND PROPRIETARY TO SAMTEC, INC. AND SHALL NOT BE REPRODUCED OR TRANSFERRED TO OTHER DOCUMENTS OR DISCLOSED TO OTHERS OR USED FOR ANY PURPOSE OTHER THAN THAT WHICH IT WAS OBTAINED WITHOUT THE EXPRESSED WRITTEN CONSENT OF SAMTEC, INC.

520 PARK EAST BLVD, NEW ALBANY, IN 47150
PHONE: 812-944-6733 FAX: 812-948-5047
e-Mail: info@SAMTEC.com code: 55322

DO NOT SCALE DRAWING SHEET SCALE: 1:0.333333
PLATING:
CONTACT AREA: .000030 GOLD OVER .000050 NICKEL
REMAINDER: .000200 REF TIN OVER .000050 NICKEL
LATCHES: .000003 GOLD OVER .000050 NICKEL

DESCRIPTION: MODIFIED ERM8 ASSEMBLY
DWG. NO. ASP-137968-01

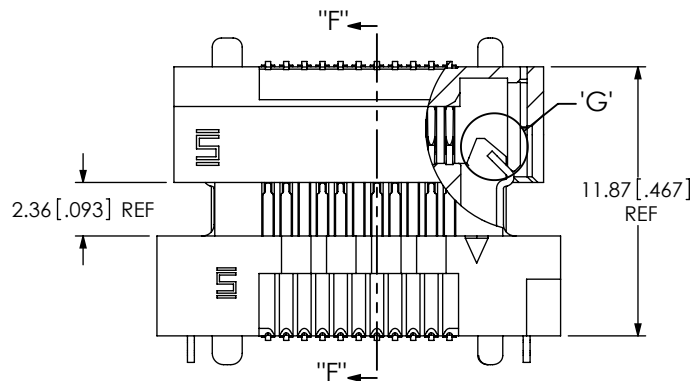

LATCH ENGAGING VIEW

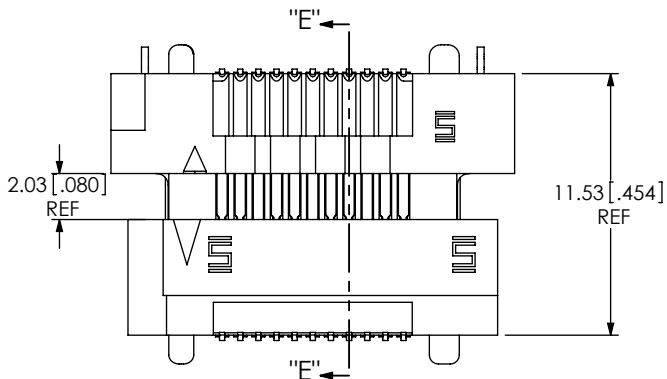

PIN ENGAGING VIEW

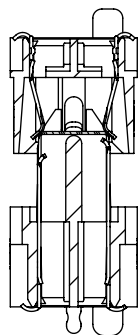

SECTION "F"-"F"

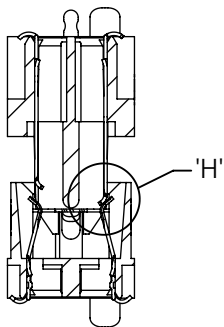

SECTION "E"-"E"

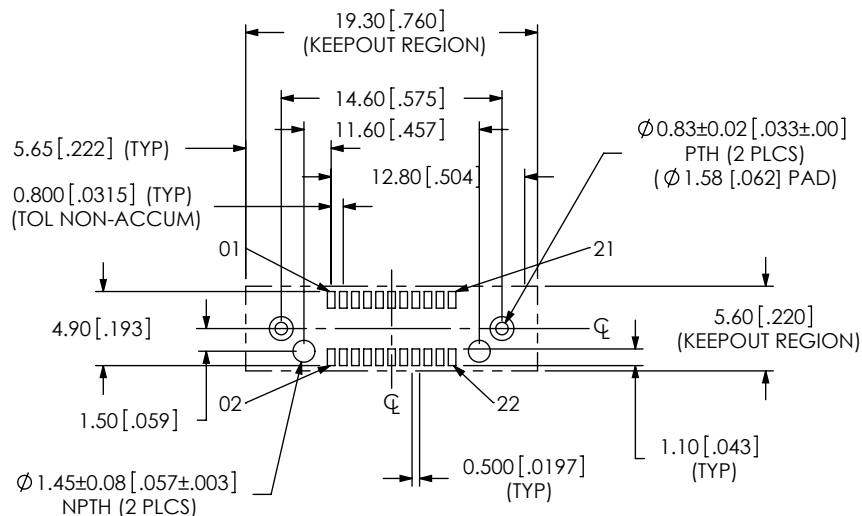

RECOMMENDED PCB LAYOUT

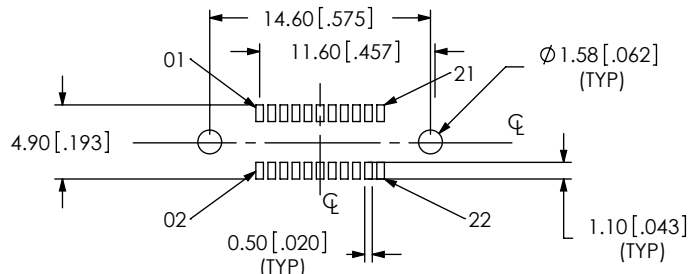

RECOMMENDED STENCIL LAYOUT

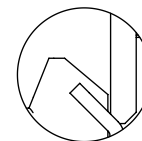

DETAIL 'G'
SCALE 6 : 1

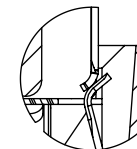

DETAIL 'H'
SCALE 6 : 1

PROPRIETARY NOTE

THIS DOCUMENT CONTAINS INFORMATION CONFIDENTIAL AND PROPRIETARY TO SAMTEC, INC. AND SHALL NOT BE REPRODUCED OR TRANSFERRED TO OTHER DOCUMENTS OR DISCLOSED TO OTHERS OR USED FOR ANY PURPOSE OTHER THAN THAT WHICH IT WAS OBTAINED WITHOUT THE EXPRESSED WRITTEN CONSENT OF SAMTEC, INC.



SHEET SCALE: 3:1

DESCRIPTION: MODIFIED ERM8 ASSEMBLY

DWG. NO. ASP-137968-01