

GENDER -J: JACK  
 TYPE -C: CABLE  
 TERMINATION -SR1: SEALED REVERSE POLARITY BULKHEAD (RG174 OR RG316)  
 ORIENTATION -ST: STRAIGHT  
 PLATING SPECIFICATION -H: 30µ" GOLD CENTER CONTACT, 3µ" GOLD OUTER CONTACT (SEE TABLE 1)

DO NOT SCALE FROM THIS PRINT

| TABLE 1 |              |                      |
|---------|--------------|----------------------|
| ITEM    | COMPONENT    | -H                   |
| 1       | HEX NUT      | SMA-NUT-001-F        |
| 2       | LOCK WASHER  | SMA-LWAS-001-F       |
| 3       | GASKET       | SMA-GKT-002          |
| 4       | SUB ASSEMBLY | SUB-SMA-J-C-F-ST-SB1 |
| 5       | PIN          | SMA-PIN-005-H        |
| 6       | FERRULE      | SMA-FER-001-F        |

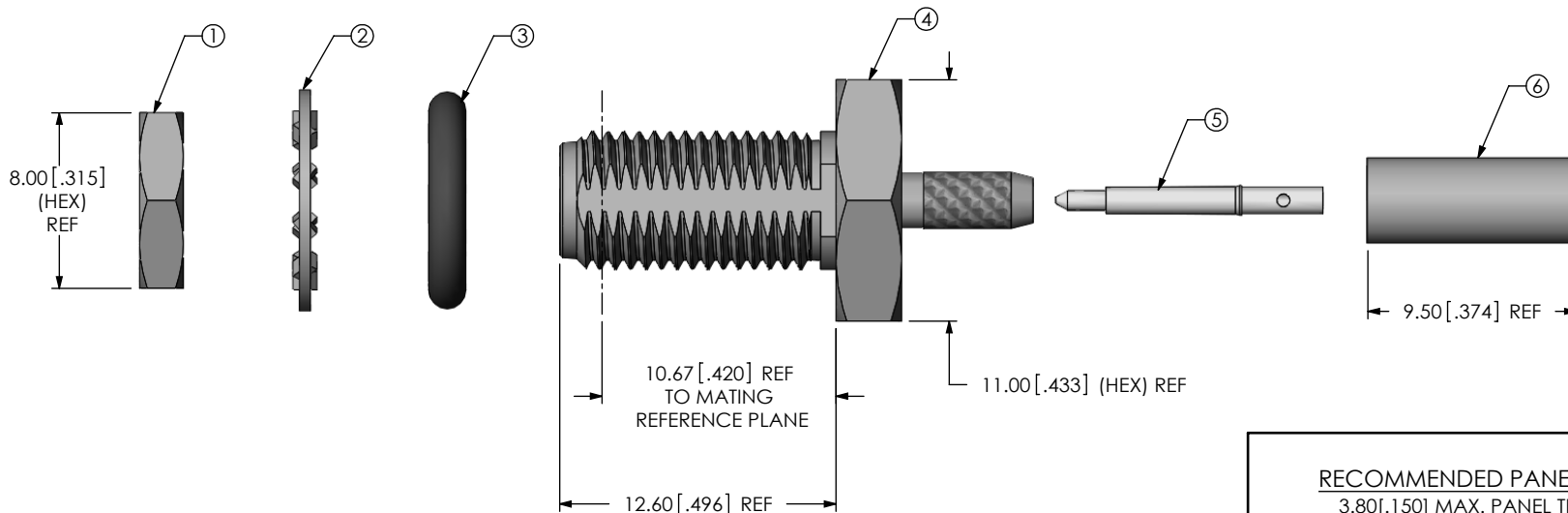

NOTES:

- ⊕ REPRESENTS A CRITICAL DIMENSION.
- NOTE DELETED.
- NOTE DELETED.
- DEL NOTE 4.
- PRODUCT TO BE PACKAGED PER PACKAGING STANDARD CO-HD-WI-3040-M.
- NOTE DELETED.
- NOTE DELETED.
- NOTE DELETED.

|  |   |  |
|--|---|--|
| UNLESS OTHERWISE SPECIFIED, DIMENSIONS ARE IN MILLIMETERS [INCHES]. TOLERANCES ARE:<br>DECIMALS ANGLES<br>.X: ±0.3 [.01] 5°<br>.XX: ±0.13 [.005]<br>.XXX: ±0.051 [.0020] | <b>PROPRIETARY NOTE</b><br>THIS DOCUMENT CONTAINS INFORMATION CONFIDENTIAL AND PROPRIETARY TO SAMTEC, INC. AND SHALL NOT BE REPRODUCED OR TRANSFERRED TO OTHER DOCUMENTS OR DISCLOSED TO OTHERS OR USED FOR ANY PURPOSE OTHER THAN THAT WHICH IT WAS OBTAINED WITHOUT THE EXPRESSED WRITTEN CONSENT OF SAMTEC, INC. | <br>520 PARK EAST BLVD, NEW ALBANY, IN 47150<br>PHONE: 812-944-6733 FAX: 812-948-5047<br>e-Mail: info@SAMTEC.com code: 55322 |
|  |   |  |
| BY: R MUSSER 04/05/2009  |   | SHEET 1 OF 2   |

REVISION E

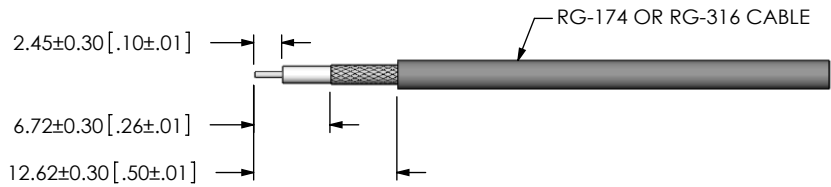

IN PROCESS 1  
STRIP AND TIN INNER  
CONDUCTOR

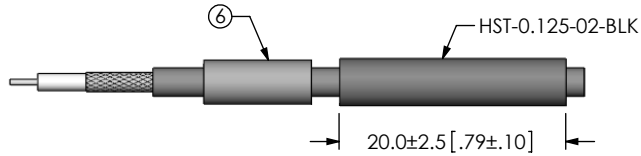

IN-PROCESS 2  
ADD HEAT SHRINK  
TUBE & FERRULE



IN-PROCESS 3  
SOLDER SIGNAL PIN

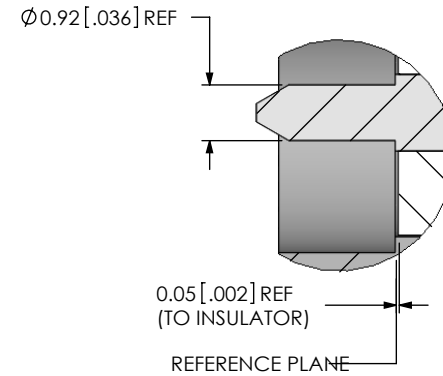

DETAIL 'A'  
SCALE 8:1

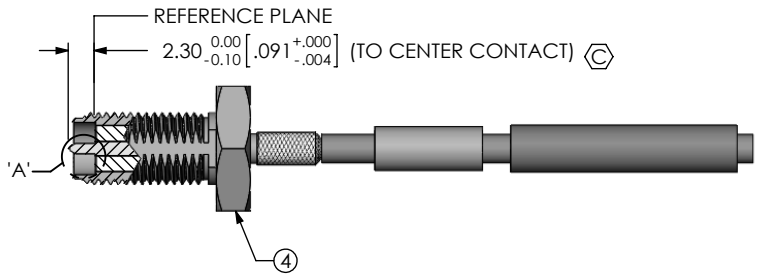

IN-PROCESS 4  
ADD SUB ASSEMBLY

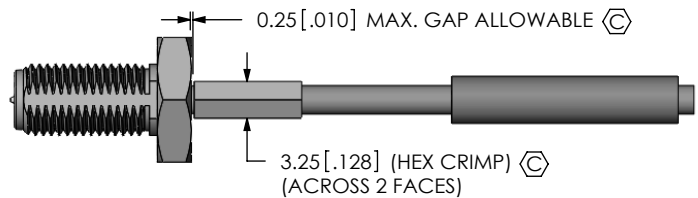

IN-PROCESS 5  
CRIMP FERRULE  
(USE CRIMP HAND TOOL  
#CAT-HT-126667-21  
OR EQUIVALENT)  
(USE .128" HEX DIE)

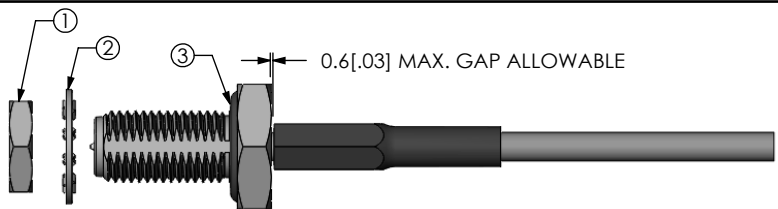

IN PROCESS 6  
APPLY HEAT SHRINK TUBING  
& ADD GASKET

F:\DWG\MISC\MKTG\SMA-J-C-X-ST-SR1-MKT.SLDDRW

PROPRIETARY NOTE

THIS DOCUMENT CONTAINS INFORMATION  
CONFIDENTIAL AND PROPRIETARY TO  
SAMTEC, INC. AND SHALL NOT BE REPRODUCED  
OR TRANSFERRED TO OTHER DOCUMENTS OR  
DISCLOSED TO OTHERS OR USED FOR ANY  
PURPOSE OTHER THAN THAT WHICH IT WAS  
OBTAINED WITHOUT THE EXPRESSED WRITTEN  
CONSENT OF SAMTEC, INC.

DO NOT SCALE DRAWING

SHEET SCALE: 1.5:1



520 PARK EAST BLVD, NEW ALBANY, IN 47150  
PHONE: 812-944-6733 FAX: 812-948-5047  
e-Mail: info@SAMTEC.com code: 55322

DESCRIPTION:  
SMA STR JACK S REV POLARITY, RG174 & RG316- 50 OHM

DWG. NO.  
SMA-J-C-X-ST-SR1

BY: R MUSSER 04/05/2009 SHEET 2 OF 2