

DESIGNED & DIMENSIONED  
IN INCHES[MILLIMETERS]

DO NOT  
SCALE FROM  
THIS PRINT

FIGURE 1  
SEAF8 MATED WITH SEAM8

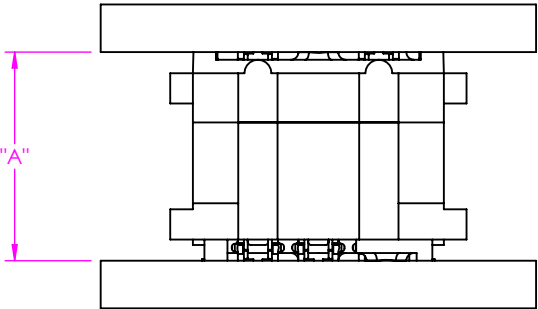

TABLE 1					
		SEAF8 LEAD STYLE		WIPE	
		-05.0			
		"A" FULLY MATED	"A" MAX	FULLY MATED	MIN @ "A" MAX
SEAM8 LEAD STYLE	-02.0	.276 [7.00]	.298 [7.57]	.037 [0.95]	.015 [0.38]
	-05.0	.394 [10.00]	.416 [10.57]	.037 [0.95]	.015 [0.38]

- NOTES:
- 1. ALL DIMENSIONS BASED ON NOMINAL VALUES FOR SAMTEC RECOMMENDED PCB LAYOUTS.
  - 2. ALTHOUGH MAX DIMENSIONS ARE LISTED SAMTEC RECOMMENDS FULLY MATING COMPONENTS.

PROPRIETARY NOTE  
THIS DOCUMENT CONTAINS INFORMATION  
CONFIDENTIAL AND PROPRIETARY TO  
SAMTEC, INC. AND SHALL NOT BE REPRODUCED  
OR TRANSFERRED TO OTHER DOCUMENTS OR  
DISCLOSED TO OTHERS OR USED FOR ANY  
PURPOSE OTHER THAN THAT WHICH IT WAS  
OBTAINED WITHOUT THE EXPRESSED WRITTEN  
CONSENT OF SAMTEC, INC.



520 PARK EAST BLVD, NEW ALBANY, IN 47150  
PHONE: 812-944-6733 FAX: 812-948-5047  
e-Mail info@SAMTEC.com code 55322

DESIGNED & DIMENSIONED  
IN INCHES[MILLIMETERS]

**FIGURE 2**  
**SEAF8-RA MATED WITH SEAM8**

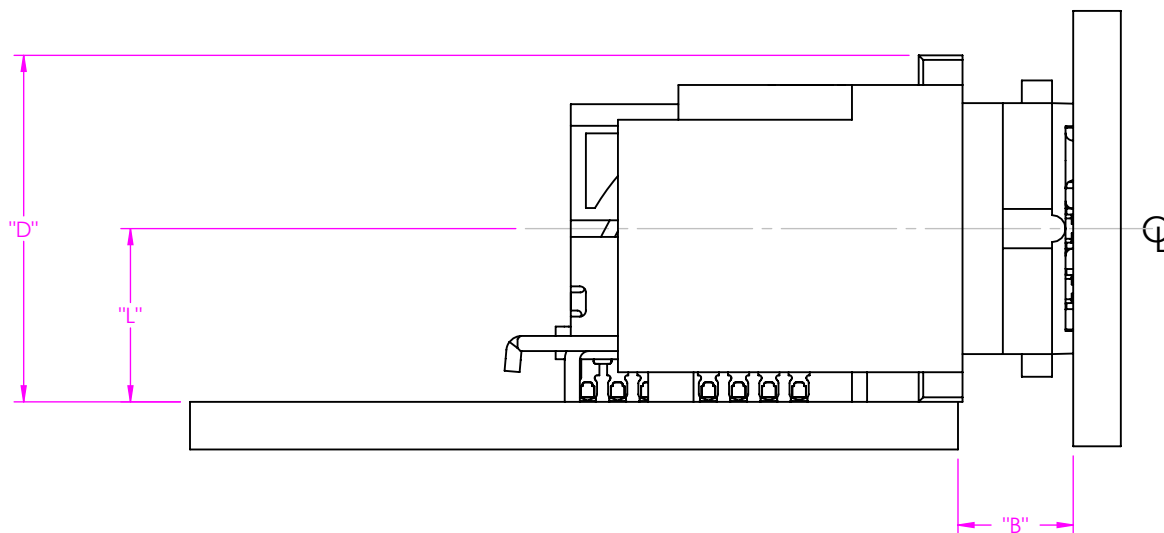

**TABLE 2**

		SEAM8-DV LEAD STYLE						WIPE	
		-02.0		-05.0		"D"	"L"	FULLY MATED	MIN @ "B" MAX
		"B" FULLY MATED	"B" MAX	"B" FULLY MATED	"B" MAX				
<b>SEAF8-RA</b> <b>No OF</b> <b>ROWS</b>	-04	.150 [3.81]	.172 [4.38]	.268 [6.81]	.291 [7.38]	.294 [7.46]	.147 [3.73]	.038 [0.96]	.015 [0.39]
	-06	.150 [3.81]	.172 [4.38]	.268 [6.81]	.291 [7.38]	.372 [9.46]	.186 [4.73]	.038 [0.96]	.015 [0.39]
	-08	.150 [3.81]	.172 [4.38]	.268 [6.81]	.291 [7.38]	.451 [11.46]	.226 [5.73]	.038 [0.96]	.015 [0.39]
	-10	.150 [3.81]	.172 [4.38]	.268 [6.81]	.291 [7.38]	.530 [13.46]	.265 [6.73]	.038 [0.96]	.015 [0.39]

**PROPRIETARY NOTE**

THIS DOCUMENT CONTAINS INFORMATION  
CONFIDENTIAL AND PROPRIETARY TO  
SAMTEC, INC. AND SHALL NOT BE REPRODUCED  
OR TRANSFERRED TO OTHER DOCUMENTS OR  
DISCLOSED TO OTHERS OR USED FOR ANY  
PURPOSE OTHER THAN THAT WHICH IT WAS  
OBTAINED WITHOUT THE EXPRESSED WRITTEN  
CONSENT OF SAMTEC, INC.

**samtec**

520 PARK EAST BLVD, NEW ALBANY, IN 47150  
PHONE: 812-944-6733 FAX: 812-948-5047  
e-Mail info@SAMTEC.com code 55322